

STILE AND RAIL/
TONGUE AND GROOVE CUTTERS

Perfect cabinet frames are achieved by the four types of quality Tungsten-Carbide tipped cutters. As the measurements of the four types are identical (differing in the profile design only), the assembly instructions on the reverse side apply for all types.

Tool No. 55350
OGEE STILE & RAIL

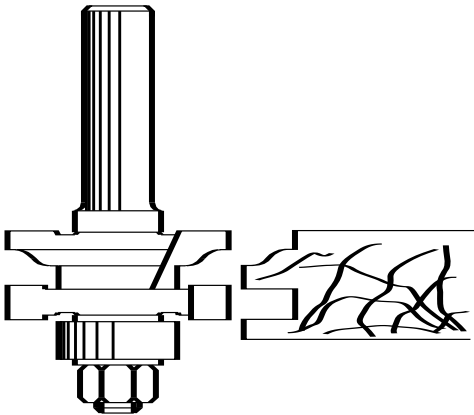

Tool No. 55380
CLASSICAL STILE & RAIL

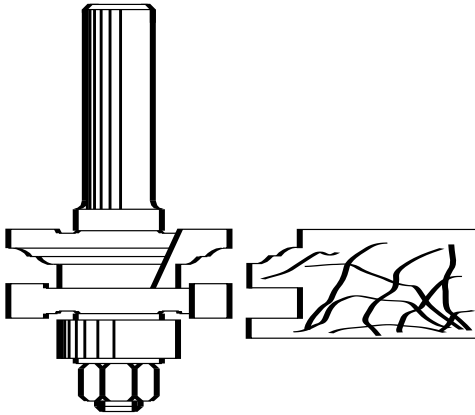

Tool No. 55370
TRADITIONAL STILE & RAIL

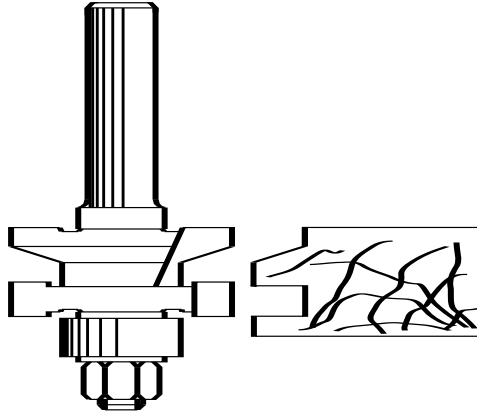

Tool No. 55400
TONGUE & GROOVE

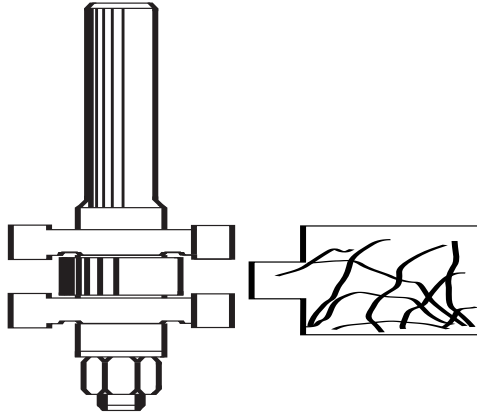

All AMANA Tools
are guaranteed against any defects
in either workmanship of material
except
tools that have been abused
or
have been damaged due to
improper maintenance.



Questions?
Call the Amana Technical Hotline @ 800-445-0077
E-Mail: tools@amanatool.com
Web Site: www.amanatool.com

PROFILE TONGUE & GROOVE CUTTER

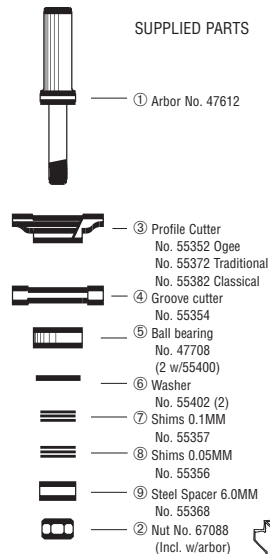

Recommended thickness of
wood is 3/4" - 7/8" (19-22MM).
At the factory, the tool was
assembled ready to cut the
tongue profile (assembly A).

In the original package, cutters
③ and ④ are placed
parallel. When working, they
should be assembled square
to each other to facilitate
cutting.

Changes in tightness can be
achieved by adding or
removing shims ⑦ or ⑧.
This is most important after
cutters have been reground.

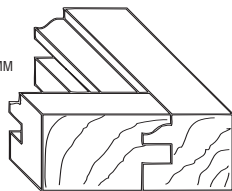

ASSEMBLY A - TONGUE PROFILE

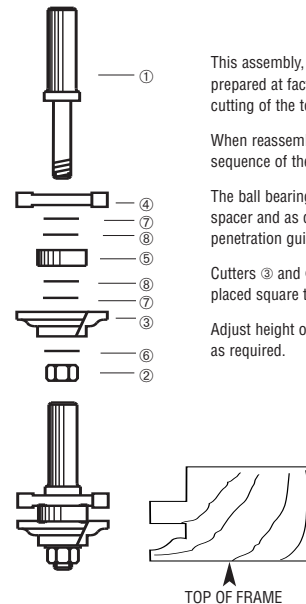

This assembly, already
prepared at factory, does the
cutting of the tongue profile.

When reassembling, follow the
sequence of the diagram.

The ball bearing acts as a
spacer and as depth of
penetration guide.

Cutters ③ and ④ are
placed square to each other.

Adjust height of tongue
as required.

ASSEMBLY B - GROOVE PROFILE

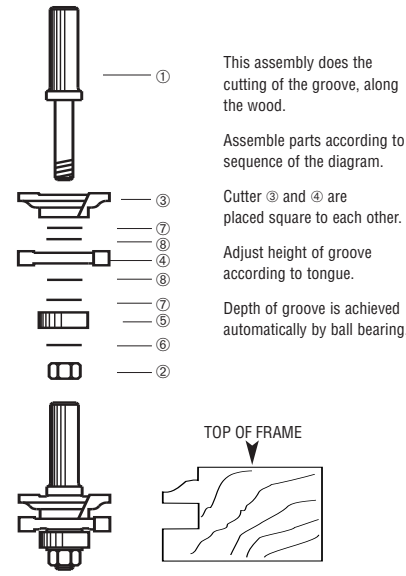

This assembly does the
cutting of the groove, along
the wood.

Assemble parts according to
sequence of the diagram.

Cutter ③ and ④ are
placed square to each other.

Adjust height of groove
according to tongue.

Depth of groove is achieved
automatically by ball bearing.

TONGUE & GROOVE CUTTER NO. 55400

ASSEMBLY A - TONGUE

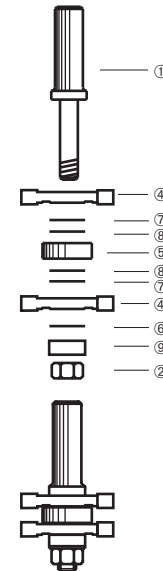

ASSEMBLY B - GROOVE

